



Paulmann

### Safety Instructions

1, 2, 3, 4, 5, 6, 7, 8, 11, 12, 13, 14, 16, 17, 19, 20, 22, 23, 24, 25, 26, 27, 28, 29, 33, 34;



31.08.2021 | 01.09.2021

ENERGY LABEL 874/2012 | ENERGY LABEL 2019/2015

A++ - A | G

www.paulmann.com/symbols

Paulmann Licht GmbH  
Quezinger Feld 2  
31832 Springe  
Germany

www.paulmann.com

Art.-Nr.: 999.74  
(+MA 326)PE0 10/20

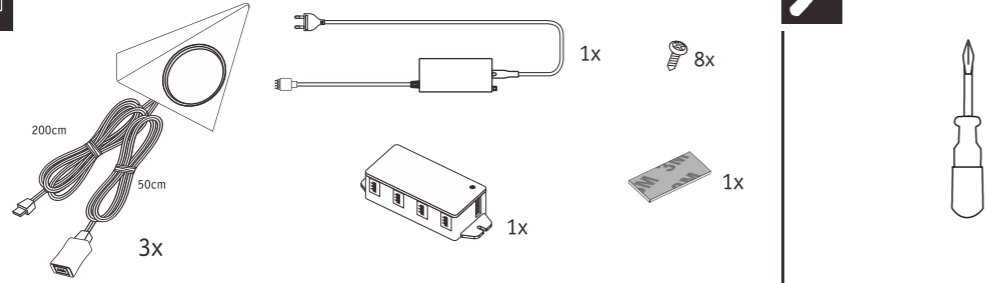

A1

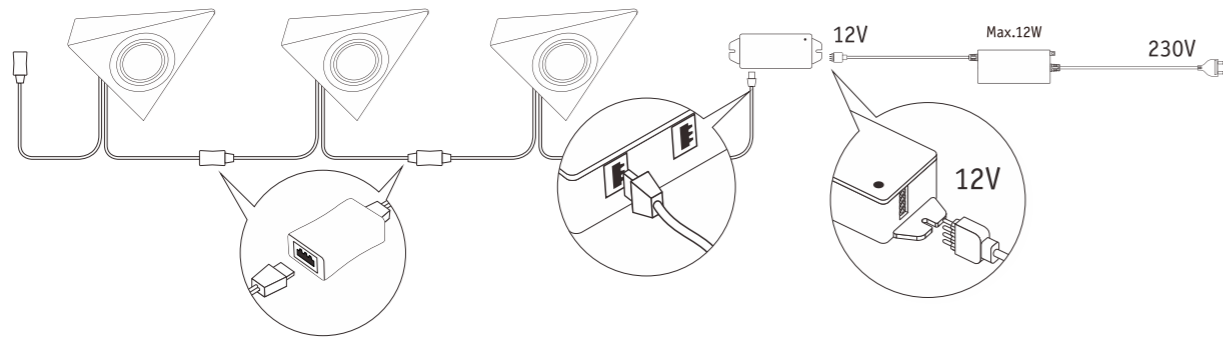

A2

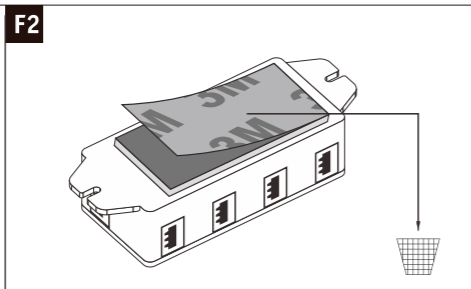
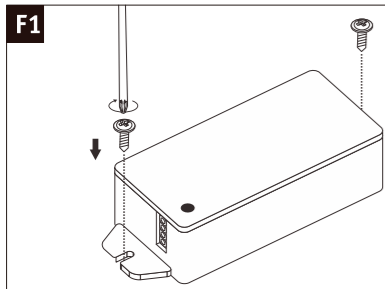
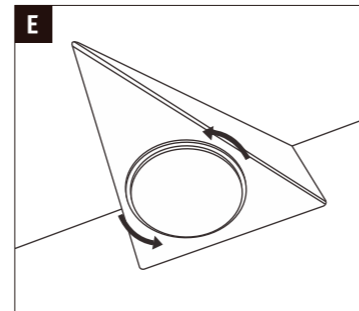
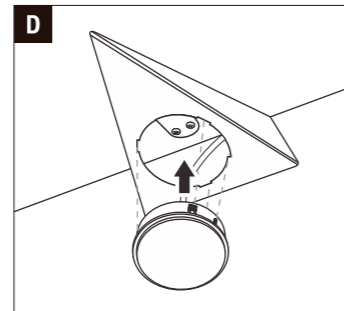
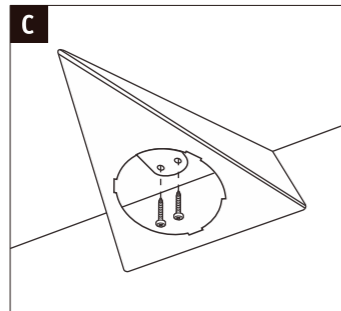
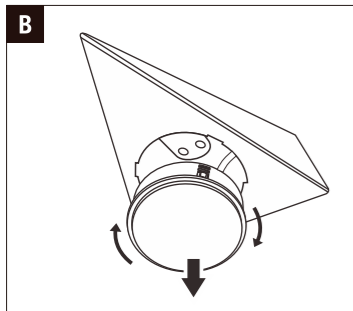
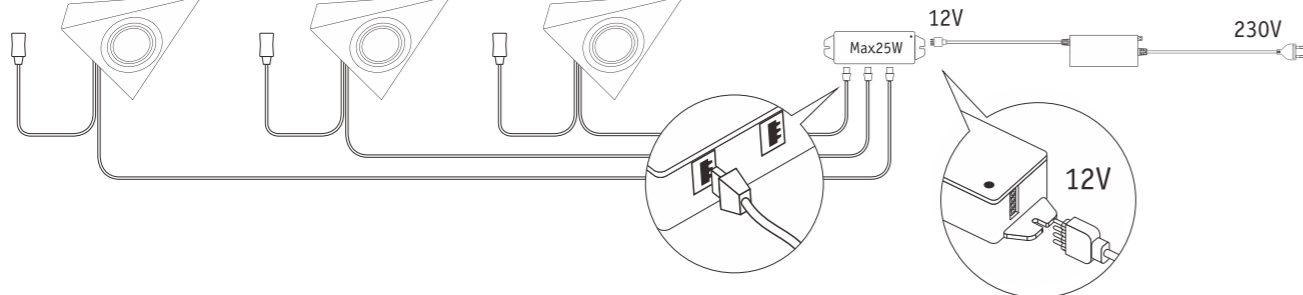

Not incl.

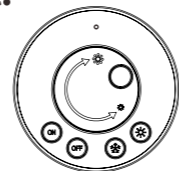

Paulmann  
Art.Nr.:999.76

### Function of keys

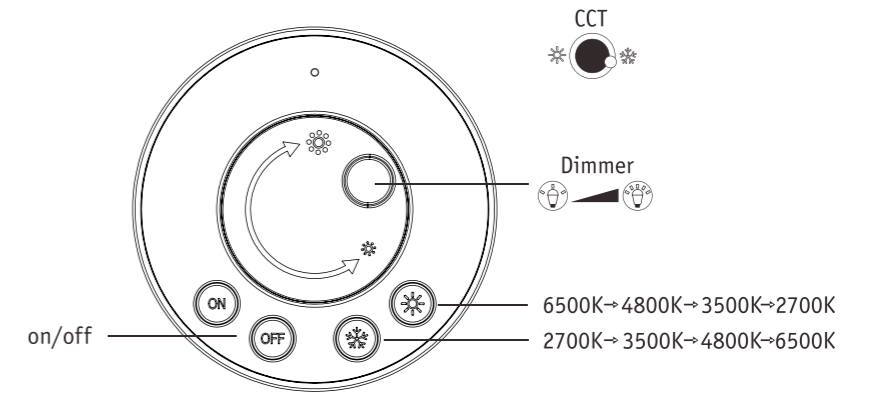

### Code Matching

(Press the "ON" button one time within 5s of connecting to the controller)

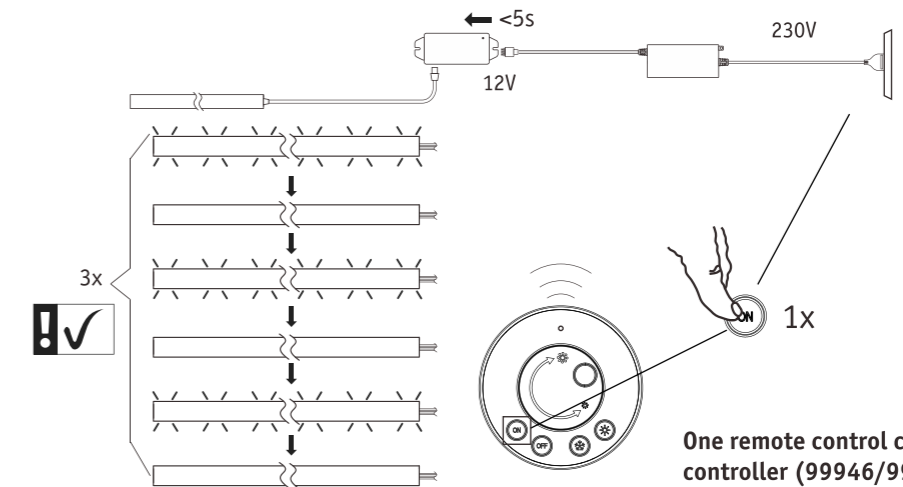

One remote control can control countless controller (99946/99947/99948), but a controller (99946/99947/ 99948) can be only controlled by 4 pcs remote control.

### Code Clearing

(Press the "NO" button three times within 5s of cancelling the connection to the controller)

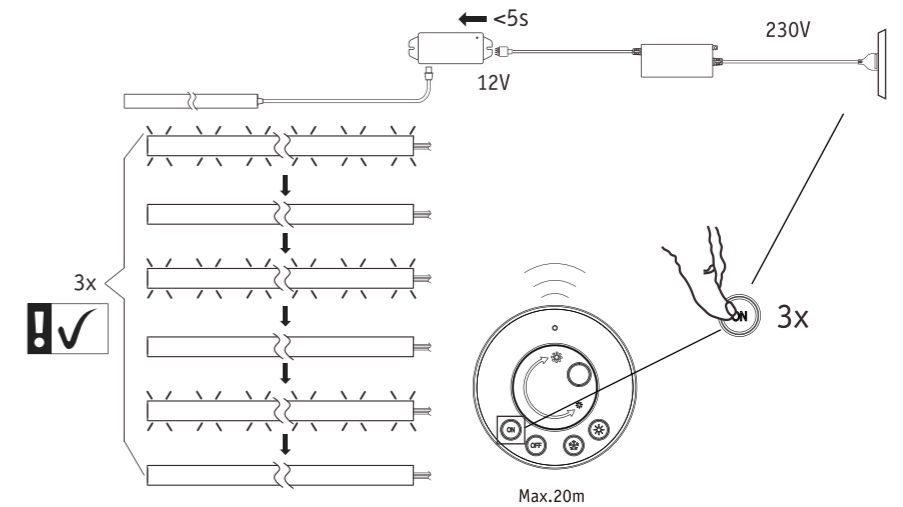

Hiermit erklärt Paulmann Licht, dass der Funkanlagentyp Art.-Nr.: 999.74 der Richtlinie 2014/53/EU entspricht. Der vollständige

Text der EU-Konformitätserklärung ist unter der folgenden Internetadresse verfügbar: [www.paulmann.de](http://www.paulmann.de)

Zugelassen für den Betrieb in allen Ländern der EU / Approved for operating in all European countries

CE: Konform mit / in accordance with / conformement a 2014/30/EU, 2014/53/EU <http://www.paulmann.com/ce>

Funk-Frequenz :2.4GHz -2.4835GHz Abgestrahlte Energie :10mW

Doesn't apply for the geographical area within a radius of 20km from the centre on "Ny Alesund"

